



WINE  
SYSTEM  
MANUAL

## Important Safeguards

To reduce the risk of fire, electric shock and/or injury to persons, basic safety precautions should always be followed when using electrical appliances, including the following:

1. **READ ALL INSTRUCTIONS BEFORE USING THE skybar™ WINE SYSTEM.**
2. To protect against electric shock, do not immerse the power cord, power plug or skybar™ Wine System in water or in any other liquid.
3. Do not operate the product with a damaged power cord or power plug or after the appliance malfunctions or has been damaged in any manner. Do not return to the place of purchase. Call 1-888-skybar9 for service.
4. The use of accessory attachments other than the manufacturer's brand products may cause hazards or injury.
5. Do not use the skybar™ Wine System outdoors.
6. Do not let the power cord hang near the edge of a table or cabinet or across a doorway. Do not allow the cord or the appliance to rest on or near hot surfaces such as a hot gas or electric burner or a heated oven.
7. Do not place the skybar™ Wine System in direct sunlight.
8. To disconnect the skybar™ Wine System, turn OFF the main power switch located at the back of the unit. Then remove the power plug from the wall outlet. Disconnect skybar™ Wine System when not in use, before user servicing and cleaning.
9. Place the appliance on a hard, flat, stable level surface.
10. Avoid contact with any moving parts.
11. The skybar™ Wine System is designed for household use only.
12. Do not use this product for anything other than its intended use. It should only be used with wine. No other liquids should be used. Liquids with pulp, sugar or syrup will clog the system. Additionally, do not use with champagne or other sparkling wines. The system will remove the bubbles in the champagne and ruin your beverage.
13. **WARNING:** If you are under 21, it is illegal for you to make or consume beer or wine in the United States.

### GOVERNMENT WARNING:

- (1) According to the Surgeon General, women should not drink alcoholic beverages during pregnancy because of the risk of birth defects.
- (2) Consumption of alcoholic beverages impairs your ability to drive a car or operate machinery, and may cause health problems.
14. Risk of electric shock. Do not attempt to open the back of the unit. There are no User Serviceable parts inside. A list of User Serviceable parts has been provided in the User Servicing Section on page 20 of this document.
15. Extra caution must be used when lifting or moving this product. It is very heavy. It is recommended that two people lift and/or move the product.
16. Use extreme care and supervision when setting up and using the product around children. Place the skybar™ Wine System in a stable location to ensure that it will not fall and cause injury.

### Save these instructions.

#### Please Note: Special Cord Set Instruction

- An appropriate-size power cord is provided to reduce the hazards resulting from a person or pet becoming entangled in or tripping over a longer cord.
- An extension cord may be purchased and used if care is exercised in its use.
- If an extension cord is used, the marked electrical rating of the extension cord must be at least as great as the electrical rating of the skybar™ Wine System. Extension cord shall be a grounding-type 3-wire cord. The complete extended cord must be arranged so that it does not hang near the edge of a table or cabinet, across a doorway or allow it to come in contact with hot surfaces.
- The skybar™ Wine System has a grounded three-prong electrical plug. It must be plugged only into a properly grounded three-prong outlet. Do not modify the plug in any way.

## WELCOME

Conceived as a stylish piece of metropolitan furniture, the skybar™ Wine System design will complement your home and impress your guests. Welcome. Enjoy.

### Placing the Unit in Your Living Space

With its contemporary design, the skybar™ Wine System is certain to complement a number of different spaces in your home. In addition to style, it's essential to also consider function when choosing the perfect location.

- When choosing a location, think about where you entertain with wine, where you keep your barware and how you want to share the skybar™ Wine System.
- Always place your skybar™ Wine System in a cool location, not directly adjacent to heat registers or radiators.
- Your skybar™ Wine System should not be placed where it would be exposed to direct sunlight, as the sun will affect the time it takes to chill the bottles and could compromise the chilling effectiveness of the unit.
- Note the need to access a 120V power outlet.
- For maximum stability, choose a level and secure location within your home.
- Avoid placing the unit in hallways, tight passages or high traffic areas.
- **DO NOT** place the skybar™ Wine System tight into a corner or tightly up against a wall. Allow at least 3 inches of space around the product for optimum performance.
- Since wine drinkers will be gathering around the system, consider any accidental spills that may occur on carpet, furniture or accessories in the area.

## **Chill** – Serve the wine at its ideal temperature

- 3 individually chilled chambers allow up to three opened wine bottles to be enjoyed at the same time at the ideal serving temperature.
- 9 wine type preset temperatures (ie: Sauvignon Blanc 45°, Chardonnay 50°, Merlot 55 ° etc..) allow to automatically chill the wine to the ideal serving temperature while taking the guesswork out of wine chilling.
- Manual temperature controls allow you to adjust each wine bottle temperature to personal liking.

## **Pour** – Enjoy wine tasting

- Pour directly into your glass for a wine tasting experience at home
- Allow your guests to select the wine they want, when they want it.
- Pour it where you drink it!

## **Preserve** – Retain the taste and aroma of the wine

- Patented vacuum technology preserves an open bottle of wine for up to 10 days by removing the oxygen that oxidizes the wine.
- Open the bottles you want, not just the one you will finish in a day! The *skybar™* Wine System protects the wine allowing you to open more bottles of wine at once and enjoy them over time.
- Satisfy everybody's taste! No need to compromise on which bottle to open. Open them all! The *skybar™* Wine System preserves the wine allowing your guests and you to enjoy your favorite wines at the same time... and without compromising!

## **Metropolitan Design**

- An elegant accent piece with an innovative blend of form and function suits a variety of lifestyles.
- Place it virtually anywhere: from the living room to the dining room from the kitchen aisle to the bar.
- Complement it with the *skybar™* Wine Stand which will create the perfect wine entertainment center anywhere in your home.

# PARTS

## skybar™ Wine System Diagram of Parts

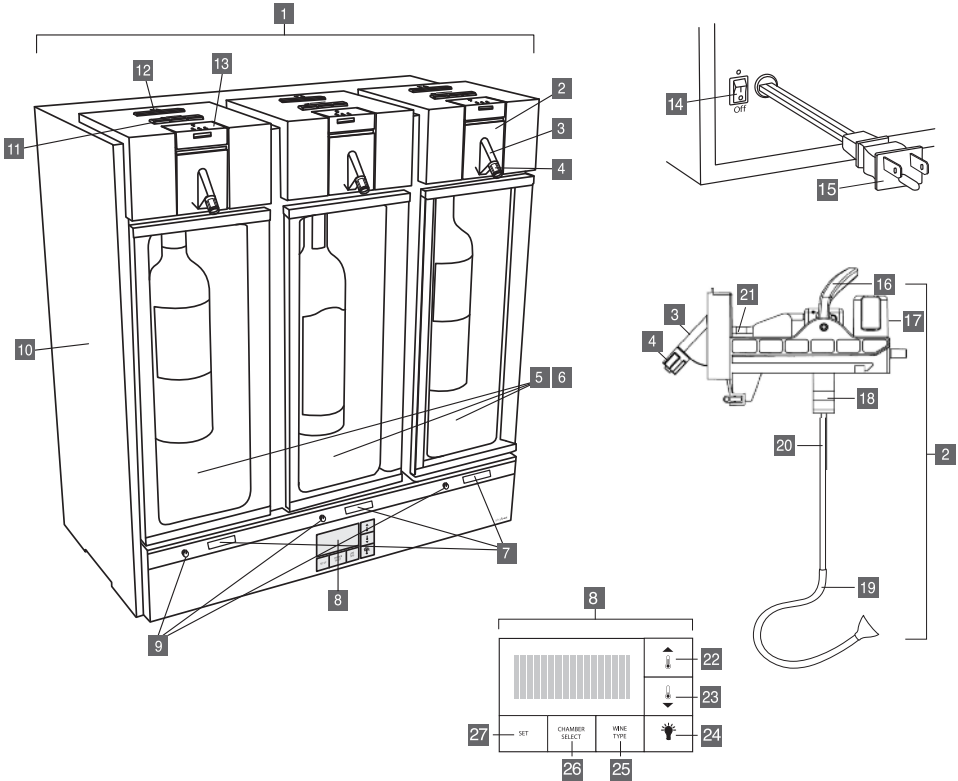

- |  |                                     |
|--|-------------------------------------|
| 1. Wine System   | 15. Power Cord                      |
| 2. Bottle Pour Assembly  | 16. Bottle Lock Lever               |
| 3. Pour Spout  | 17. Reserve Cup                     |
| 4. Pour Tip (with O-rings)   | 18. Bottle Stopper                  |
| 5. Chamber Door(s)   | 19. Bottle Tube (lower) with filter |
| 6. Chilling Chamber  | 20. Bottle Tube (upper)             |
| 7. Chill Status (LED Light)  | 21. Pour Tube                       |
| 8. Control Panel   | 22. Up Temperature Control ↑        |
| 9. Individual Chamber On/Off Button  | 23. Down Temperature Control ↓      |
| 10. Cabinet  | 24. Chamber Lights Button ✨         |
| 11. Preserve/Unlock to Pour Button  | 25. Wine Type Button                |
| 12. Replace Bottle Button           | 26. Chamber Select Button           |
| 13. Pour Button                     | 27. Set Button                      |
| 14. Main Power Button  |                                     |

## Setup

After choosing an appropriate location within your home and safely placing the skybar™ Wine System, it is time to set up your skybar™ Wine System.

1. Before using the skybar™ Wine System for the first time, it is recommended that you rinse each of the Bottle Pour Assemblies. They are fully submersible and can be washed by hand. (DO NOT PUT IN DISHWASHER—NOT DISHWASHER SAFE.) Soap can noticeably affect the flavors of fine wine, which is why most wine connoisseurs simply give their glasses a hot water rinse. With this in mind, it is possible, and recommended, to clean the Bottle Pour Assembly with just a thorough hot water flush. Rinse until you see water run clear. Dry with a soft cloth or paper towel or allow it to air-dry.
2. To attach the glass doors to the unit:
  - Carefully remove each glass door from its protective packaging (being careful to place on a soft padded surface so as not to scratch the glass)
  - Identify the (short) end of the glass door that contains the “longer hinge pin” and hold the door in a way that positions this pin to the upper left corner of the door. Always grasp the door securely so as not to drop it! (See Figure A)
  - Carefully and fully insert the long hinge pin (on the top of the door) up into the upper hinge mount located on the front of the skybar™ Wine System. (See Figure B)

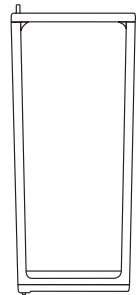

Figure A

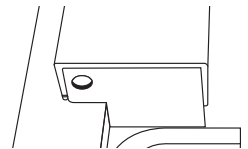

Figure B

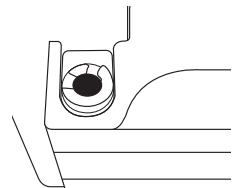

Figure C

## SETUP

- After having fully inserted the upper hinge pin into the upper mount, carefully move the lower hinge pin into place, allowing it to securely rest into the lower hinge mount located on the front of the skybar™ Wine System. (**Note:** The lower hinge pin can most easily be inserted into the lower hinge mount if the hinge pin is brought into place from the LEFT SIDE of the hinge mount. (See Figure C)
  - Before releasing the door, please check that the door is securely seated into the hinge mounts. The door should now swing open and close freely. (Please repeat the steps above for the remaining 2 glass doors)
3. Plug the unit into a 120V power outlet. (See Figure A.)
  4. Switch the Main Power Button to “on” located on the back of the unit. (see figure A.)

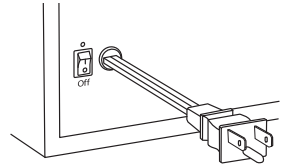

Figure A

After the unit is switched on, you will hear all three Chilling Chambers cycle on and begin to chill and attempt to preserve. If there are no bottles in place, the preservation cycle will stop automatically after several seconds.

The three Chilling Chambers are factory preset to a temperature of 50°F/10°C. You can select the temperature within each Chilling Chamber individually. (See Setting the Temperature on page 12)

The skybar™ Wine System utilizes an advanced solid state thermoelectric technology for chilling, this product does not contain a refrigerant such as those used in compressor type refrigeration systems.

If the temperature in your home rises above 80°F, 27°C or 60% relative humidity for an extended period of time, there is a possibility of condensation occurring which could cause damage to your unit. Please remove wine bottles from the unit and turn the unit OFF if you will be away from your home for more than a week.



## INSTALLING BOTTLES

### Installing or Replacing Wine Bottles

It's suggested to install or replace wine bottles onto the Bottle Pour Assembly in the kitchen. To install a wine bottle:

1. Open the Chilling Chamber door.
2. Please grasp the bottle or pour spout as you unlock it to disengage the Bottle Pour Assembly. Press the Replace Bottle Button on the top of the unit. The Bottle Pour Assembly locking mechanism will release. (See Figure B.)
3. Slide the Bottle Pour Assembly forward until it has cleared the chamber opening. (See Figure C.)
  - a. If you are installing a wine bottle into an empty Chilling Chamber, take the Bottle Pour Assembly to your kitchen.
  - b. If you are removing the Bottle Pour Assembly with a bottle attached, support the bottom of the bottle and take it to your kitchen. (See Figure D.) Do not unlock the Bottle Pour Assembly from the bottle until you are in your kitchen, at the sink or over a countertop.
4. Always rinse the Bottle Pour Assembly thoroughly between bottles. For the proper technique, refer to Care and Cleaning on page 17.

**Note:** In order to avoid wine spillage, never remove the pour tip from the pour spout unless you are at the kitchen sink.

#### SUGGESTION

#### MAKE AN EXCHANGE WITHOUT MAKING A MESS.

When adding or removing a bottle from the Bottle Pour Assembly, prevent spillage by doing so at the kitchen sink.

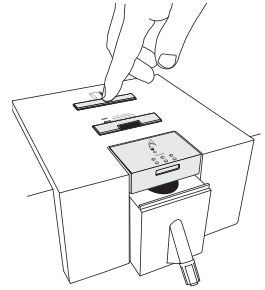

Figure B

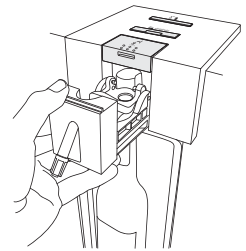

Figure C

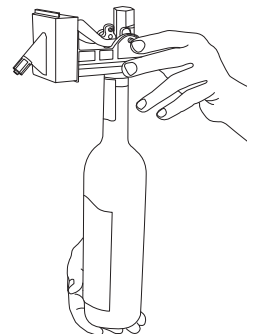

Figure D

## INSTALLING BOTTLES

5. Uncork the bottle of wine and remove the foil wrap around the bottle neck. (This system is optimized for use with wine bottles with corks and may be used for some screw cap bottles but not all, as they may not properly fit the system.) Pour a sample and taste to ensure that the wine is of desired quality.
6. Examine inside the neck of the bottle to ensure that no loose pieces of cork or foil will obstruct the seal between the bottle neck and the Bottle Pour Assembly.
7. Lift the Bottle Lock Lever into the vertical (open) position. (See Figure E.)
8. Align the front of the bottle with the front of the Bottle Pour Assembly, so that the wine label is aligned with the Pour Spout and Pour Tip. This will ensure that the bottle label will be visible when the Bottle Pour Assembly is locked and placed into the Chilling Chamber.

### Important note:

- **To chill a un-opened bottle, please call 1-888-skybar9 (1-888-759-2279) to order the Chill Only Assembly Accessory Part.**
- **NEVER** operate the skybar™ Wine System to chill an un-opened bottle without the Bottle Pour Assembly or Chill Only Assembly in place.

SUGGESTION	<b>CONDUCT A THOROUGH INSPECTION.</b>
	Once you've opened a new bottle, ensure that the neck is free of cork or foil before loading into the skybar™ Wine System.

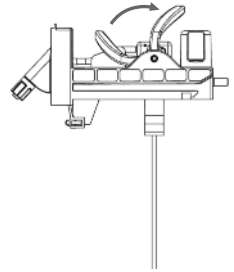

Figure E

SUGGESTION	<b>PROPER ETIQUETTE SAYS TASTE WINE BEFORE SERVING.</b>
	Take a sip of wine prior to loading a new bottle into the skybar™ Wine System. This ensures the wine is satisfactory to your tastes prior to preserving and serving.

## INSTALLING BOTTLES

9. Place the Bottle Tube fully into the bottle. Ensure the rubber bottle stopper at the top of the Bottle Tube is fully and firmly inserted into the bottle. (See Figure F.)
10. Press the Bottle Lock Lever downward into the horizontal (closed) position to lock the Bottle Pour Assembly to the wine bottle. Gently tug upward on the Bottle Pour Assembly to confirm that it is securely mounted to the bottle. (See Figure G.)
11. While supporting the wine bottle from the bottom, transport the bottle with the Bottle Pour Assembly to your skybar™ Wine System. (See Figure D.)
12. Open the door and slide the Bottle Pour Assembly into the unit, continuing to support the wine bottle from the bottom, until you hear the Bottle Pour Assembly lock into place. (See Figure C.)
13. Close the Chilling Chamber door.
  - The Preserve/Unlock to Pour Button light will blink while you hear the preservation process begin. The amber light will stop blinking and will remain lit once the wine has reached the preservation mode.
  - The Chilling Chamber will automatically begin chilling to 50°F/10°C. To adjust the temperature further, you may use one of the nine Wine Type Preset Temperatures or manually set a different temperature.
  - For optimum performance be sure to close the chamber door when in operation.

**Note:** If the door is left open the chamber will shut off after 1 hour.

SUGGESTION

### FACE THE LABEL TO THE FRONT.

Turn the bottle so the label is facing front before locking and loading to the Bottle Pour Assembly.

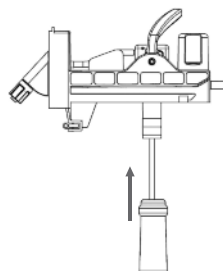

Figure F

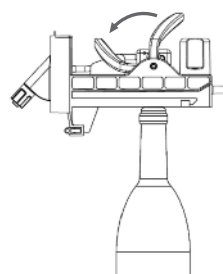

Figure G

## SETTING THE TEMPERATURE

### Selecting the Temperature



It is important to serve wines at the right temperature. The skybar™ Wine System allows you to choose the temperature you prefer within a range of 45°F/7°C to 68°F/20°C. You can set the desired temperature manually or choose one of the nine skybar™ Wine Type Preset Temperatures provided:

1. Press the “Set” Button. (See Figure H.) Three icons will appear, each representing one of the three Chilling Chambers and the current set temperature for each chamber will be displayed within the chamber icons. (See Figure I.)

2. Press the “Chamber Select” Button. (See Figure I.) Press repeatedly until the Chilling Chamber you want to set is highlighted. (Chamber with a temperature shown)

3. Set the temperature.

a. Once you have selected the desired chamber, you can select one of the nine Wine Type Preset Temperatures, press the “Wine Type” Button. (See Figure J.) Press it repeatedly until your Wine Type Preset of choice is highlighted. (See Figure K.)

b. To set the temperature manually, simply press the Up Temperature Control  or Down Temperature Control Button  until your desired temperature is displayed inside the chamber icon. (See Figure L.)

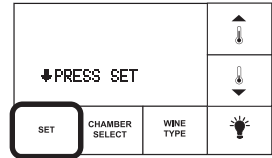

Figure H

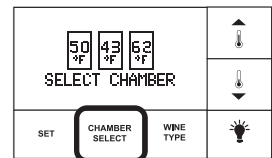

Figure I

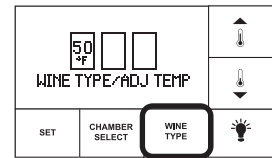

Figure J

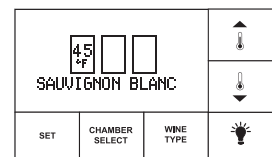

Figure K

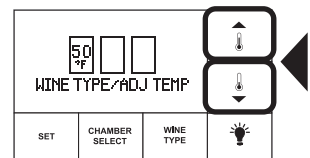

Figure L

SUGGESTION

**DON'T LET THE MOOD—OR THE WINE—DROP.**

Once a bottle is attached to the Bottle Pour Assembly, always support the bottom of the bottle.

## TEMPERATURE PRESETS

- To save the setting, press the "Set" Button. The adjusted Chilling Chamber(s) will blink, then the display will turn off after three seconds. The chamber will begin to chill the wine to your selected setting (If you forget to press the "Set" Button, the control will automatically save and turn off after 30 seconds).
- Repeat this process to set the other Chilling Chambers. You do not have to press "Set" in between selecting temperatures for multiple chambers.

### SUGGESTION

#### TAKE CONTROL OR LET IT TAKE CARE OF ITSELF.

Nine preset temperature settings are conveniently available for a variety of wines, or you can customize to your own tastes by adjusting the temperature manually.

### WINE TYPE RECOMMENDED PRESET TEMPERATURES\*

Wine	Temperature
Sauvignon Blanc	45°F/7°C
Pinot Grigio	45°F/7°C
Chardonnay	50°F/10°C
White Zinfandel	50°F/10°C
Pinot Noir	50°F/10°C
Merlot	55°F/13°C
Cabernet Sauvignon	65°F/18°C
Shiraz	65°F/18°C
Red Zinfandel	65°F/18°C

\*It is suggested that wines to be chilled below 55° F / 11° C could be pre-chilled in a household refrigerator for 3 hours.

For recommended serving temperatures for additional wine types, please visit [skybarhome.com](http://skybarhome.com). Personal preferences may vary.

#### Important note:

- An Indicator Light will illuminate when the wine has reached an appropriate drinking temperature. (#7 on page 6)
- The chilling time will vary based on the initial temperature of the bottle, the room temperature and the Chilling Chamber SET temperature. The best way to know your wine has reached the desired temperature is to wait for the white LED Chill Status to illuminate.

## CHANGING TEMPERATURE SCALE

### Changing Temperature Scale

The skybar™ Wine System allows you to choose the temperature scale you prefer Celsius (C) or Fahrenheit (F).

- To select between “C” or “F” temperature scales press and hold both of the temperature control buttons for 3 seconds. (See Figure M.)

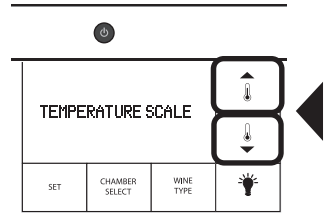

Figure M

- Once the Temperature Scale Selection screen is displayed, press either  $\uparrow$  or  $\downarrow$  depending on the scale you prefer.

### For Optimum Performance

- Close the doors, the display will indicate if a door is left open. After 60 minutes, if the door is left open, the corresponding chamber will shut off.

### Important note:

For optimum cooling, thermoelectric products like skybar™ Wine System should be in an environment with a room temperature of less than 70°F (21°C). A higher room temperature will result in a slightly warmer internal chamber temperature.





For example, if your room temperature is 72°F (22°C), the coldest your wine chambers will reach is approximately 48°F (9°C).

Please reference below chart for approximate room temperatures and the resulting coldest internal wine chamber temperatures:

Approx. Room Temperature	Approx. Internal Wine Chamber Temperature
68°F (20°C)	45°F (7°C)
70°F (21°C)	46°F (8°C)
72°F (22°C)	48°F (9°C)
73°F (23°C)	50°F (10°C)
75°F (24°C)	52°F (11°C)
77°F (25°C)	54°F (12°C)

## Pouring Wine

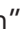
Each Chilling Chamber chills, pours, and preserves independently of each other. The buttons to operate preservation and pouring for each individual chamber are located on top of the unit. (See Figure N.)

1. When the amber light is illuminated on the "Preserve/Unlock to Pour" Button , the Chilling Chamber is in preservation mode. Simply press the "Preserve/Unlock to Pour" Button to release the wine from preservation mode and enable the Pour feature.
2. A solid green indicator light on the "Pour Button"  will indicate that the bottle is released from preservation mode and is ready to pour. Be sure the chamber door is closed prior to pouring.
3. Hold the glass directly under the Pour Spout before pressing the "Pour Button" , as wine will begin to flow soon after you press the button.
4. Press and hold the "Pour Button"  to dispense wine. Wine can only be dispensed from one bottle at a time. Never open the chamber door while pouring wine.
5. Release the "Pour Button"  and allow the last drop to flow out before pulling the glass away from the Pour Spout.
  - At this time, the green Pour Button indicator light remains lit, and you can continue to pour additional glasses.
  - The bottle will return to preservation mode automatically after 30 minutes of system inactivity. You can manually return the bottle to preservation mode by pressing the "Preserve/Unlock to Pour" Button . The amber light on the "Preserve/Unlock to Pour" Button will blink while the bottle is being returned to preservation mode.

Many wines will contain sediment that settles in the bottom of the bottle. The skybar™ Wine System is designed to leave a small amount of wine in the bottom of every "finished" bottle to avoid dispensing this unwanted sediment.

**Note:** Never operate the unit without the Pour Tip in place.

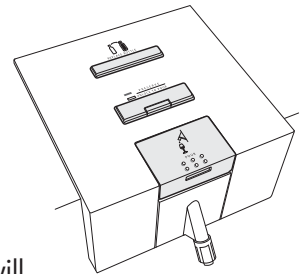
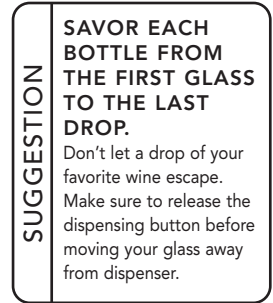

Figure N

## A Note About Wine Preservation

Once a bottle of wine has been uncorked, oxygen comes into contact with the wine and begins a chemical change called oxidation. Once oxidation begins, it cannot be stopped, but fortunately, it can be slowed! The skybar™ Wine System removes oxygen from the bottle, which slows the rate of oxidation and keeps your wine preserved for a longer period of time.

Different wines will oxidize at different rates. For this reason, it is difficult to predict exactly how long a specific wine will last. Some wines, even stored in a vacuum or inert gas, will oxidize more quickly. Wine is best enjoyed up to ten days after opening.

## Care and Cleaning

To ensure superior performance, it is important to clean and care for your skybar™ Wine System. With proper care, you will eliminate cross-contamination of wine flavor and maintain optimal operation.

Switch off and disconnect Wine System. Do Not Immerse.

### Exterior Care

1. Clean the exterior housing with a slightly damp cloth or light duty furniture polish. (NEVER use an abrasive cleaner on the exterior.)
2. Very special care should be exercised when cleaning a high polished cabinet exterior, avoid using an abrasive sponge or cleaning pad, as this may scratch and damage the unit.
3. Clean the Chilling Chamber doors with a household glass cleaner.
4. Clean the Control Panel, the Pour Spout and surrounding area and all buttons with a slightly damp cloth. Liquids should never be poured or sprayed near buttons or on or near the Pour Spout or Control Panel.
5. The interior of the Chilling Chambers and the rear panel can also be cleaned with a slightly damp cloth.
6. There is an air filter located at the back of the unit, occasionally remove and rinse with water, let air-dry and then reinstall.



## Bottle Pour Assembly Care

1. The Bottle Pour Assembly is fully submersible and can be safely cleaned with water. Soap can noticeably affect the flavors of fine wine, which is why most wine connoisseurs simply give their glasses a hot water rinse. With this in mind, it is possible, and recommended, to clean the Bottle Pour Assembly with just a thorough hot water flush. (DO NOT PUT IN DISHWASHER—NOT DISHWASHER SAFE.)
2. Rinsing the Bottle Pour Assembly is recommended between each bottle of wine, especially when changing from one type of wine to another. This prevents cross contamination of wine flavor between different types of wine.
  - Lift the Bottle Lock Lever into the vertical (open) position (see Figure E) and remove the Bottle Pour Assembly from the empty bottle. There may be some residual wine in the tube so carefully carry to a sink to clean.
  - Remove the Pour Tip by sliding it out from the Pour Spout. This will allow any remaining liquids to flow out and air and water to pass through the Bottle Pour Assembly for cleaning. (DO OVER THE SINK!)
  - Run the Bottle Tube under water, causing water to flow through the Bottle Pour Assembly and out the Pour Spout.
  - There is a filter located at the bottom of the Bottle Tube to keep any sediment that may be at the bottom of the wine bottle from clogging the system. When cleaning, be sure to run water through this filter to clear any sediment that may remain.
  - The Bottle Pour Assembly features a Reserve Chamber that captures any wine that may be inadvertently drawn into the vacuum system. To clean this bottle, simply unscrew it from the Bottle Pour Assembly, rinse out with warm water and air dry.
3. Shake the Bottle Pour Assembly. Dry with a soft cloth or paper towel or allow it to air-dry.
4. Rinse the Pour Tip under water, and dry with a soft cloth or paper towel. Securely replace the Pour Tip onto the Bottle Pour Assembly by sliding it back into place into the Pour Spout ensuring the O-ring seal is intact.

SUGGESTION

**HIGH AND DRY.**

After cleaning the Bottle Pour Assembly, allow it to dry completely to ensure that no water dilutes your next bottle of wine.

## Troubleshooting

Your skybar™ Wine System has been carefully designed to give you many years of trouble-free service. In the unlikely event that your skybar™ Wine System does not operate satisfactorily, please review the following potential problems and try the steps recommended BEFORE you call an authorized service center.

To order replacement parts or for additional help with product questions, please call 1-888-SKYBAR9 (1-888-759-2279).

Problem	Recommended Steps
<b>Power</b>	
1. The skybar™ Wine System does not turn on.	<ul style="list-style-type: none"> <li>• Ensure that the skybar™ Wine System is plugged into an outlet.</li> <li>• Ensure that the outlet has power.</li> <li>• Ensure that the individual chamber power buttons are "ON".</li> </ul>
2. The skybar™ Wine System turns on, but an individual chamber is not working.	<ul style="list-style-type: none"> <li>• Ensure that the individual chamber power button is on.</li> </ul>
3. Lights are flashing.	<ul style="list-style-type: none"> <li>• Open and close the Chilling Chamber door to reset.</li> <li>• Remove the Bottle Pour Assembly and wash it thoroughly then replace.</li> </ul>
<b>Controls</b>	
4. Nothing is displayed on the control panel.	<ul style="list-style-type: none"> <li>• Press the Set Button.</li> <li>• Ensure that the Main Power Button is on and that there is power to the unit (See No.1).</li> </ul>
<b>Dispensing/Pouring</b>	
5. Pressing the Replace Bottle Button does not release the Bottle Pour Assembly.	<ul style="list-style-type: none"> <li>• Open door first, press and hold the Replace Bottle Button, reach into the Chilling Chamber and gently pull the Bottle Pour Assembly toward you.</li> </ul>

Problem	Recommended Steps
<b>Dispensing/Pouring</b>	
6. Wine does not pour when the Pour Button is pressed.	<ul style="list-style-type: none"><li>• Ensure that the wine bottle is installed correctly onto the Bottle Pour Assembly and that the Bottle Pour Assembly is securely engaged into the Chilling Chamber (see page 8).</li><li>• Ensure that the Pour Tip is installed onto the Pour Spout properly and is securely tightened.</li><li>• Press the Pour Button when the green light is illuminated.</li><li>• <i>Note: If the green light is not illuminated and the amber light is illuminated, press the Preserve/ Unlock to Pour Button, which will stop preservation, turn off the amber light and enable pouring, indicated by the green light (see page 14).</i></li><li>• Wine will not dispense if the chamber or another chamber is actively in the preservation mode.<ul style="list-style-type: none"><li>– Wait for the preservation cycle to be completed within the chamber in which that function is in-process, or</li><li>– Cancel the preservation process by pressing the Preservation Button of that chamber where vacuum is being created.</li></ul></li></ul>
7. If the chamber you are trying to pour from still is not pouring.	<ul style="list-style-type: none"><li>• Wait for the preservation cycle to be completed within the chamber in which that cycle is in-process.</li><li>• Or to cancel the preservation process press the Preservation Button of that chamber(s) where vacuum is being created. The preservation button(s) will have a flashing amber light simply press the button(s) it to stop preservation. This then should enable you to pour from any chamber.</li></ul>

Problem	Recommended Steps
<b>Dispensing/Pouring</b>	
8. A wine bottle is securely installed but preservation mode is not working.	<ul style="list-style-type: none"> <li>• If a wine bottle is installed, the lights should be amber or green. If no lights are illuminated, neither the preservation mode nor the pour mode is active.</li> <li>• Open the Chilling Chamber door and ensure the bottle is installed correctly onto the Bottle Pour Assembly and that the Bottle Pour Assembly is engaged into the Chilling Chamber. Close the door, and the system should reset.</li> <li>• Ensure the Pour Tip is tightened onto the Pour Spout. If you have reinstalled the Pour Tip, reset the preservation mode by opening and closing the door after you have reinstalled the Pour Tip. Preservation should begin and the amber light should illuminate (see page 14).</li> <li>• Remove the Pour Tip by sliding it out from the Pour Spout. This will allow any remaining liquids to flow out and air and water to pass through the Bottle Pour Assembly for cleaning. (DO OVER THE SINK!)</li> </ul>
9. Wine is pouring slowly	<ul style="list-style-type: none"> <li>• Ensure that the wine bottle is installed correctly onto the Bottle Pour Assembly and that the Bottle Pour Assembly is securely engaged into the Chilling Chamber.</li> <li>• Ensure that the Pour Tip is installed onto the Pour Spout properly and is securely tightened.</li> <li>• Clean the Bottle Tube and the Pour Tip by running clean water through the system or following the cleaning instructions (see page 15). Dry all parts and reinstall.</li> <li>• Replace the Pour Tip and reset the Chilling Chamber function by opening and closing the door.</li> </ul>

Problem	Recommended Steps
<b>Dispensing/Pouring</b>	
10. The Pour Tip drips.	<ul style="list-style-type: none"> <li>• Ensure that the Pour Tip is installed onto the Pour Spout properly and is securely tightened.</li> <li>• Clean the Pour Tip (see page 16).</li> <li>• Replace the Pour Tip and reset the Chilling Chamber function by opening and closing the door.</li> </ul>
11. There are bubbles moving from the Bottle Tube into the bottle of wine.	<ul style="list-style-type: none"> <li>• <i>Note: The skybar™ Wine System is attempting to preserve your wine, but the seal is not closed, which is essential to enabling it to preserve.</i></li> <li>• Ensure that the Pour Tip is securely tightened to the Pour Spout.</li> <li>• Ensure that the O-ring is in place on the Pour Tip. If the O-ring is missing, you will need to replace the Pour Tip.</li> <li>• Clean the O-ring and the Pour Spout and recheck the seal.</li> </ul>
12. The wine bottle will not securely install onto the Bottle Pour Assembly.	<ul style="list-style-type: none"> <li>• Ensure that the Bottle Lock Lever is in the vertical (open) position, enabling you to insert the Bottle Tube into the bottle and install the bottle securely onto the Bottle Pour Assembly.</li> <li>• Press the Bottle Lock Lever into the horizontal (closed) position to attach it to the bottle.</li> <li>• Ensure your bottle has a cork, not a screw cap. This system is for use with wine bottles with corks and not for use with screw cap bottles as they may not all properly fit the system.</li> </ul>

## User Serviceable Parts and Installation

### User Serviceable Parts

1. Air Inlet Filter (3-pack)
2. Chamber Door Assembly
3. Bottle Pour Assembly
4. Refresh Kit: 1 Set: Pour Tip with O-ring Seals, Short Pour Tube and Long Bottle Tube
5. Cabinet Touch-Up Marker
6. Chill "Only" Assembly Accessory

For more information on these parts and other accessories visit [skybarhome.com](http://skybarhome.com) or call 1-888-SKYBAR9.

### Did You Know?

- Chardonnay is America's most popular white wine.
- One grape cluster (approx. 75 grapes) produces one 4-oz. glass of wine.
- One vine will produce about 10 bottles.
- The biggest wine bottle made is called a Nebuchadnezzar – equal to fifteen 750ml bottles of wine! (Sorry, this giant won't fit in the skybar™ Wine System.)
- There are 20 million acres of wine grapes planted worldwide.
- All grape juice is clear. Red wines get their color when the juice sits in contact with the red grape skins during fermentation.
- Wines in the United States are named for the grape they are made from. Wines in Europe are named for the place they are made. Bordeaux and California Cabernet Sauvignon are both made from Cabernet Sauvignon grapes.
- In the US, to list an appellation – e.g. "Napa Valley" – on the label, at least 85% of the wine's grapes must have been grown there. To list a varietal – e.g. "Chardonnay" – at least 75% of the blend must be of Chardonnay.

SUGGESTION

**LOWER TEMPERATURES. HIGHER ENJOYMENT.**  
Make sure to place your skybar™ Wine System away from heating vents, direct sunlight or any other sources of significant light or heat.

## Service and Maintenance

If your skybar™ Wine System requires service, do not return it to the store where you purchased it. All repairs and replacements must be made by an authorized service center. Please call us at the following toll-free telephone number for service.

### **U.S. 1-888-SKYBAR9 (1-888-759-2279)**

You may also visit our website at [skybarhome.com](http://skybarhome.com) to contact us.

To assist us in serving you, please have the skybar™ Wine System model number and date purchased available when you call. The model number is located next to the master power switch on the back of the unit.

We welcome your questions, comments or suggestions. In all your communications, please include your complete name, address, telephone number and a description of the problem.







## One-Year Limited Warranty

Sunbeam Products, Inc. doing business as Jarden Consumer Solutions or if in Canada, Sunbeam Corporation (Canada) Limited doing business as Jarden Consumer Solutions (collectively "JCS") warrants that for a period of one year from the date of purchase, this product will be free from defects in material and workmanship. JCS, at its option, will repair or replace this product or any component of the product found to be defective during the warranty period. Replacement will be made with a new or remanufactured product or component. If the product is no longer available, replacement may be made with a similar product of equal or greater value. This is your exclusive warranty. Do NOT attempt to repair or adjust any electrical or mechanical functions on this product. Doing so will void this warranty.

This warranty is valid for the original retail purchaser from the date of initial retail purchase and is not transferable. Keep the original sales receipt. Proof of purchase is required to obtain warranty performance. JCS dealers, service centers, or retail stores selling JCS products do not have the right to alter, modify or any way change the terms and conditions of this warranty.

This warranty does not cover normal wear of parts or damage resulting from any of the following: negligent use or misuse of the product, use on improper voltage or current, use contrary to the operating instructions, disassembly, repair or alteration by anyone other than JCS or an authorized JCS service center. Further, the warranty does not cover: Acts of God, such as fire, flood, hurricanes and tornadoes.

### **What are the limits on JCS's Liability?**

JCS shall not be liable for any incidental or consequential damages caused by the breach of any express, implied or statutory warranty or condition.

Except to the extent prohibited by applicable law, any implied warranty or condition of merchantability or fitness for a particular purpose is limited in duration to the duration of the above warranty.

## **One-Year Limited Warranty** (continued)

JCS disclaims all other warranties, conditions or representations, express, implied, statutory or otherwise.

JCS shall not be liable for any damages of any kind resulting from the purchase, use or misuse of, or inability to use the product including incidental, special, consequential or similar damages or loss of profits, or for any breach of contract, fundamental or otherwise, or for any claim brought against purchaser by any other party.

Some provinces, states or jurisdictions do not allow the exclusion or limitation of incidental or consequential damages or limitations on how long an implied warranty lasts, so the above limitations or exclusion may not apply to you.

This warranty gives you specific legal rights, and you may also have other rights that vary from province to province, state to state or jurisdiction to jurisdiction.

### **How to Obtain Warranty Service**

If you have any question regarding this warranty or would like to obtain warranty service, please call 1-888-SKYBAR9 or 1-888-759-2279 and a convenient service center address will be provided to you.

In the U.S.A., this warranty is offered by Sunbeam Products, Inc. doing business as Jarden Consumer Solutions located in Boca Raton, Florida 33431. In Canada, this warranty is offered by Sunbeam Corporation (Canada) Limited doing business as Jarden Consumer Solutions, located at 20 B Hereford Street, Brampton, Ontario L6Y 0M1. If you have any other problem or claim in connection with this product, please write our Consumer Service Department.

**PLEASE DO NOT RETURN THIS PRODUCT TO ANY OF THESE ADDRESSES OR TO THE PLACE OF PURCHASE.**



© 2008 Sunbeam Products, Inc. doing business as Jarden Consumer Solutions.  
All rights reserved. Distributed by Sunbeam Products, Inc. doing business as  
Jarden Consumer Solutions, Boca Raton, Florida 33431.

1-888-skybar9

[www.skybarhome.com](http://www.skybarhome.com)

Printed in China.

SPR-070708

Part No. 122576